

AMENDMENTS:		
AMENDMENT	DATE	DESCRIPTION

- NOTES:
- 1) This plan has been prepared for sewer asbuilt purposes only. No liability is accepted if the plan is used for any other purpose.
 - 2) Any measurements taken from information which is not dimensioned on the electronic copy are at the risk of the recipient.
 - 3) All sewer laterals are 100mmØ uPVC unless otherwise specified.
 - 4) All lateral positions have been provided by C & A Cox and have not been verified. No liability is accepted in relation to their locations.
 - 5) All roading and footpath information is asbuilt.
 - 6) Origin of Levels:
SS 11A SO 797
Brass Plaque
RL=9.42m
- All levels in terms of Lyttelton Vertical Datum 1937. Levels pre 2010 & 2011 Canterbury earthquakes.

LEGEND

LL=	LID LEVEL
IL=	INVERT LEVEL
SANITARY SEWER	MH SEWER LATERAL
EXISTING SANITARY SEWER	EX.MH EX. SEWER LATERAL
ASBUILT KERB AND CHANNEL	CUTDOWN
ASBUILT FOOTPATH	



116 Wrights Road P O Box 679 Christchurch 8140, New Zealand
Telephone: 03 379-0793 Website: www.dls.co.nz E-mail: office@dls.co.nz

JOB TITLE:
Rosemerryn - Stage 17

SHEET TITLE:
Sewer Asbuilt

DRAWING STATUS:
Asbuilt

SCALE: 1:500@A1
1:1000@A3 DATE: April 2023

CAD FILE: J:\20448\ASBUILTS\E20448_AB_R0.dwg DRAWN: JS
DRAWING No: SHEET No: REVISION:
E.20448.AB.SS01 RO

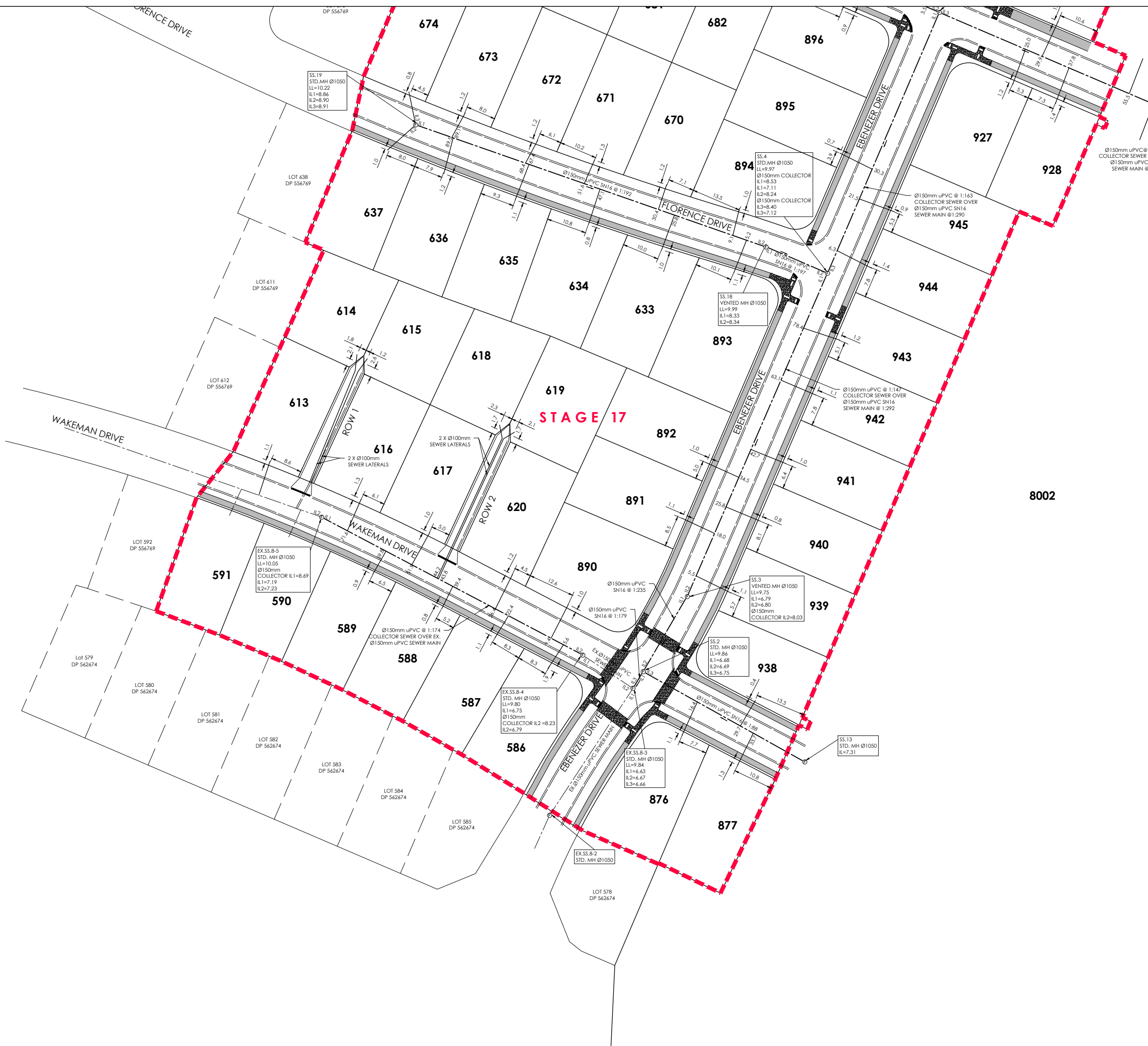
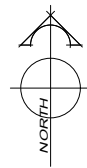

AMENDMENTS:		
AMENDMENT	DATE	DESCRIPTION

- NOTES:
- 1) This plan has been prepared for sewer asbuilt purposes only. No liability is accepted if the plan is used for any other purpose.
 - 2) Any measurements taken from information which is not dimensioned on the electronic copy are at the risk of the recipient.
 - 3) All sewer laterals are 100mmØ uPVC unless otherwise specified.
 - 4) All lateral positions have been provided by C & A Cox and have not been verified. No liability is accepted in relation to their locations.
 - 5) All roading and footpath information is asbuilt.
 - 6) Origin of Levels:
SS 11A SO 797
Brass Plaque
RL=9.42m
- All levels in terms of Lyttelton Vertical Datum 1937. Levels pre 2010 & 2011 Canterbury earthquakes.

LEGEND

LL=	LID LEVEL	
IL=	INVERT LEVEL	
SANITARY SEWER	MH	SEWER LATERAL
EXISTING SANITARY SEWER	EX.MH	EX. SEWER LATERAL
ASBUILT KERB AND CHANNEL		CUTDOWN
ASBUILT FOOTPATH		

DAVIE LOVELL-SMITH
PLANNING SURVEYING ENGINEERING

116 Wrights Road P O Box 679 Christchurch 8140, New Zealand
Telephone: 03 379-0793 Website: www.dls.co.nz E-mail: office@dls.co.nz

JOB TITLE:
Rosemerryn - Stage 17

SHEET TITLE:
Sewer Asbuilt

DRAWING STATUS:
Asbuilt

SCALE: 1:500@A1 DATE: April 2023
1:1000@A3

CAD FILE: J:\20448\ASBUILTS\E20448 AB_R0.dwg DRAWN: JS
DRAWING No: SHEET No: REVISION:
E.20448.AB.SS02 RO

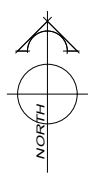
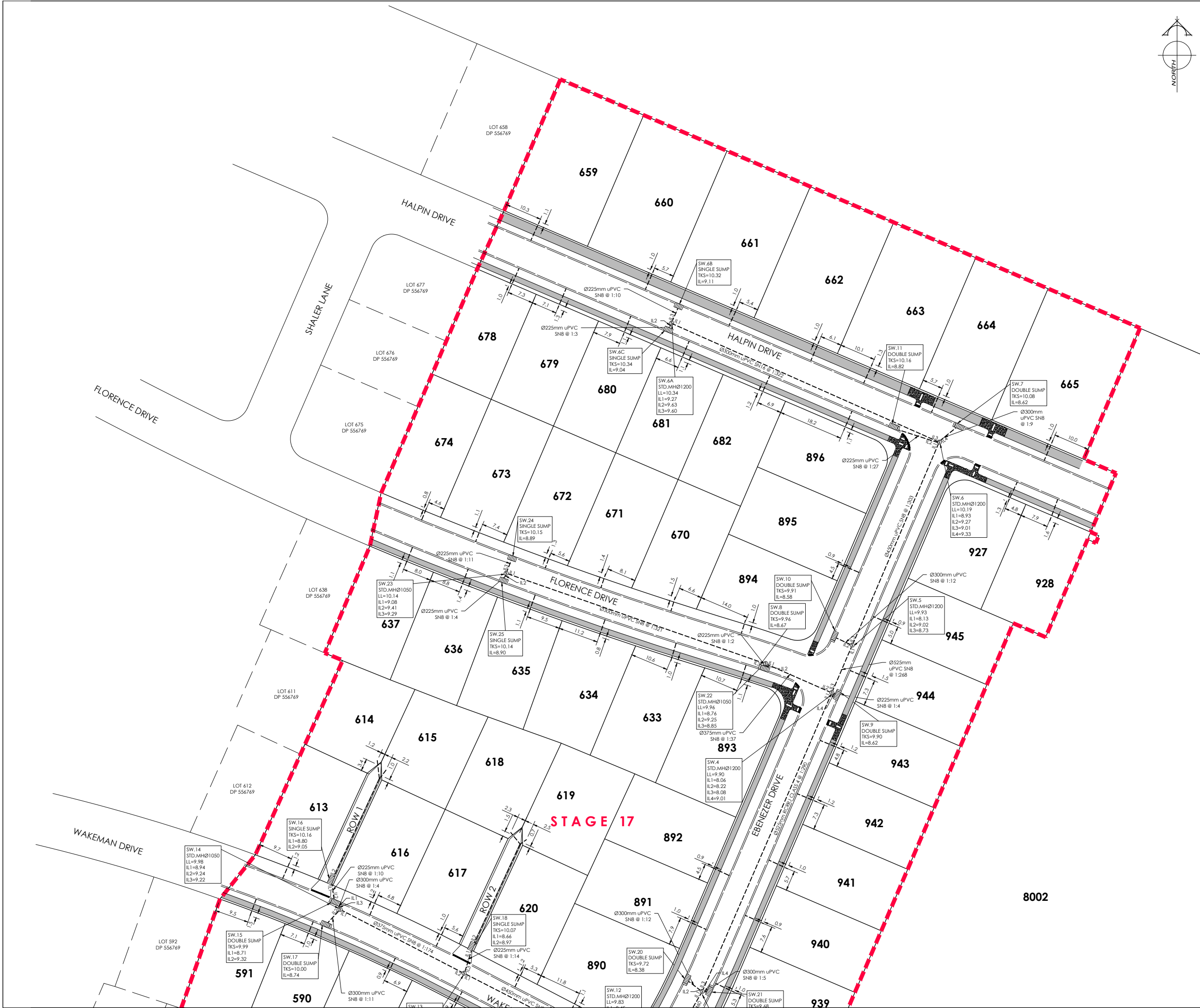

AMENDMENTS:		
AMENDMENT	DATE	DESCRIPTION

- NOTES:
- This plan has been prepared for stormwater asbuilt purposes only. No liability is accepted if the plan is used for any other purpose.
 - Any measurements taken from information which is not dimensioned on the electronic copy are at the risk of the recipient.
 - All roading and footpath information is asbuilt.
 - Origin of Levels:
SS 11A SO 797
BRASS PLAQUE
RL=9.42m.

All levels in terms of Lyttelton vertical datum 1937. Levels pre 2010 & 2011 Canterbury earthquakes.
 - All connection to kerb adapters are evident on site.
 - All stormwater laterals are Ø10mm uPVC SN16.
 - The lateral positions haven been provided by C & A Cox Ltd and haven not been verified. No liability is accepted in relation to their locations.

LEGEND

STORMWATER	---	MH
EXISTING STORMWATER	---	EX.MH
ASBUILT KERB AND CHANNEL	---	SUMP DOUBLE SUMP
ASBUILT FOOTPATH	---	CUTDOWN

DAVIE LOVELL-SMITH
PLANNING SURVEYING ENGINEERING

116 Wrights Road P O Box 679 Christchurch 8140, New Zealand
Telephone: 03 379-0793 Website: www.dls.co.nz E-mail: office@dls.co.nz

JOB TITLE:
Rosemerryn - Stage 17

SHEET TITLE:
Stormwater Asbuilt

DRAWING STATUS:
Asbuilt

SCALE: 1:500@A1
1:1000@A3 DATE: April 2023

CAD FILE: J:\20448\ASBUILTS\E20448 AB_R0.dwg DRAWN: JS
DRAWING No.: SHEET No.: REVISION:
E.20448.AB.SW01 RO



AMENDMENTS:

AMENDMENT	DATE	DESCRIPTION

NOTES:

- This plan has been prepared for stormwater asbuilt purposes only. No liability is accepted if the plan is used for any other purpose.
- Any measurements taken from information which is not dimensioned on the electronic copy are at the risk of the recipient.
- All roading and footpath information is asbuilt.
- Origin of Levels:**
SS 11A SO 797
BRASS PLAQUE
RL=9.42m.

All levels in terms of Lyttelton vertical datum 1937. Levels pre 2010 & 2011 Canterbury earthquakes.
- All connection to kerb adopters are evident on site.
- All stormwater laterals are Ø10mm uPVC SN16.
- The lateral positions have been provided by C & A Cox Ltd and have not been verified. No liability is accepted in relation to their locations.

LEGEND

STORMWATER	---	MH
EXISTING STORMWATER	---	EX.MH
ASBUILT KERB AND CHANNEL	▬	SUMP DOUBLE SUMP
ASBUILT FOOTPATH	▬	CUTDOWN

DAVE LOVELL-SMITH
PLANNING SURVEYING ENGINEERING

116 Wrights Road P O Box 679 Christchurch 8140, New Zealand
Telephone: 03 379-0793 Website: www.dls.co.nz E-mail: office@dls.co.nz

JOB TITLE:
Rosemerryn - Stage 17

SHEET TITLE:
Stormwater Asbuilt

DRAWING STATUS:
Asbuilt

SCALE: 1:500@A1 DATE: April 2023
1:1000@A3

CAD FILE: J:\20448\ASBUILTS\E20448.AB.R0.dwg	DRAWN: JS
DRAWING No: E.20448.AB.SW02	REVISION: RO

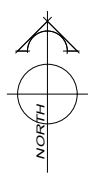
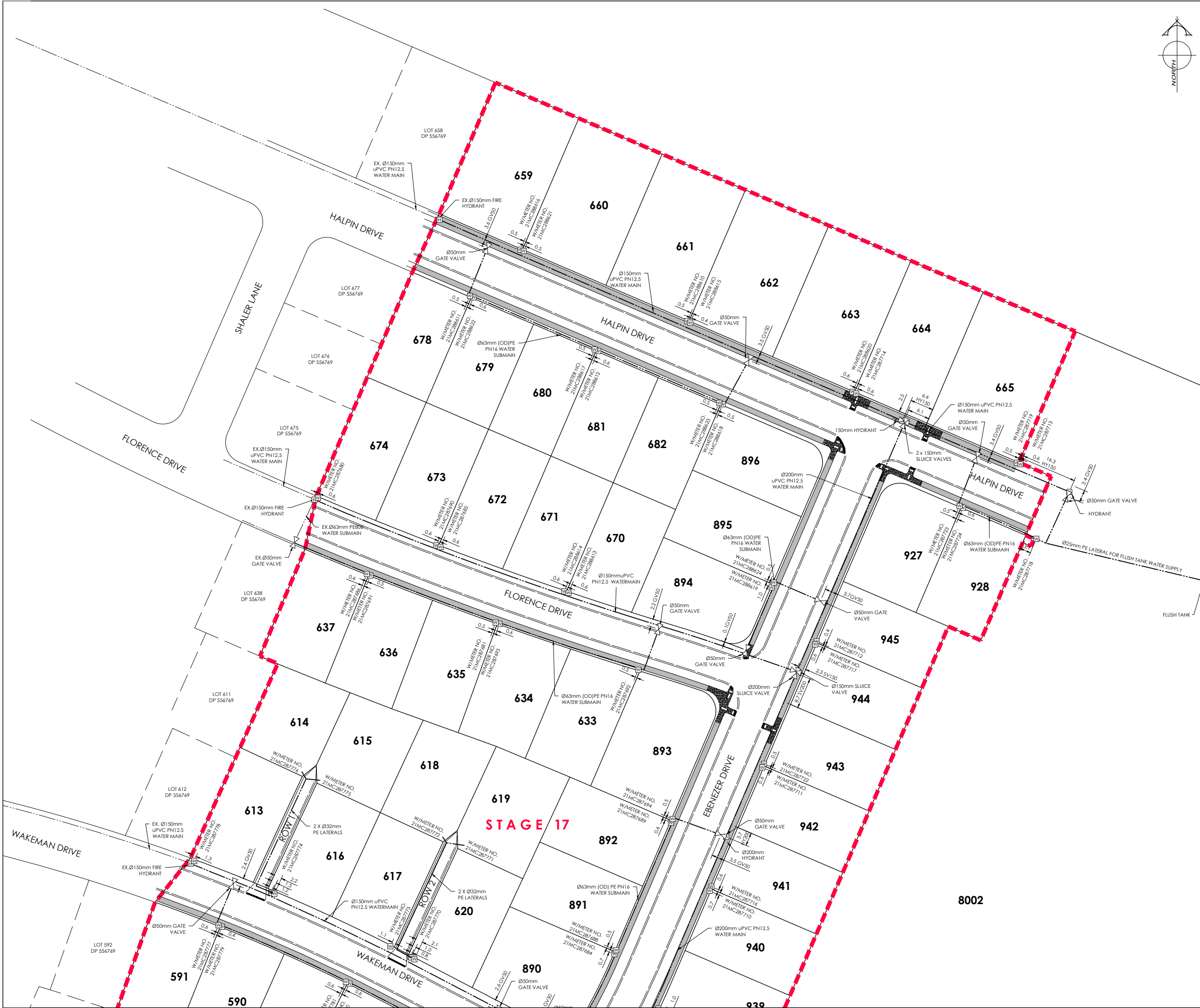

AMENDMENTS:		
AMENDMENT	DATE	DESCRIPTION

- NOTES:
- 1) This plan has been prepared for water asbuilt purposes only. No liability is accepted if the plan is used for any other purpose.
 - 2) Any measurements taken from information which is not dimensioned on the electronic copy are at the risk of the recipient.
 - 3) Location of submain and water mains provided by C & A Cox. No liability is accepted in relation to their locations.
 - 4) All house connections are 25mm poly and include gate valve, toby box, tapping band and farrale.
 - 5) All water laterals are Ø25mm PE BlueLine PN12.5 with associated fittings unless otherwise specified.
 - 6) All roading information is asbuilt.

LEGEND

WATER		FH VALVE		CONNECTION	
EXISTING WATER					
ASBUILT KERB AND CHANNEL					
ASBUILT FOOTPATH					

DAVIE LOVELL-SMITH
PLANNING SURVEYING ENGINEERING

116 Wrights Road P O Box 679 Christchurch 8140, New Zealand
Telephone: 03 379-0793 Website: www.dls.co.nz E-mail: office@dls.co.nz

JOB TITLE:
Rosemerryn - Stage 17

SHEET TITLE:
Water Asbuilt

DRAWING STATUS:
Asbuilt

SCALE: 1:500@A1
1:1000@A3 DATE: April 2023

CAD FILE: J:\20448\ASBUILTS\E20448_AB_R0.dwg	DRAWN: JS
DRAWING No: E.20448.AB.WS01	REVISION: RO

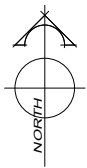

AMENDMENTS:		
AMENDMENT	DATE	DESCRIPTION

- NOTES:
- 1) This plan has been prepared for water asbuilt purposes only. No liability is accepted if the plan is used for any other purpose.
 - 2) Any measurements taken from information which is not dimensioned on the electronic copy are at the risk of the recipient.
 - 3) Location of submain and water mains provided by C & A Cox. No liability is accepted in relation to their locations.
 - 4) All house connections are 25mm poly and include gate valve, toby box, tapping band and farrale.
 - 5) All water laterals are Ø25mm PE BlueLine PN12.5 with associated fittings unless otherwise specified.
 - 6) All roading information is asbuilt.

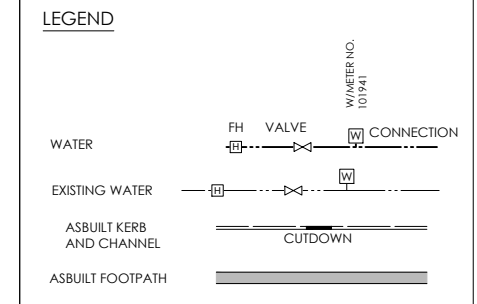

DAVIE LOVELL-SMITH
PLANNING SURVEYING ENGINEERING

116 Wrights Road P O Box 679 Christchurch 8140, New Zealand
Telephone: 03 379-0793 Website: www.dls.co.nz E-mail: office@dls.co.nz

JOB TITLE:
Rosemerryn - Stage 17

SHEET TITLE:
Water Asbuilt

DRAWING STATUS:
Asbuilt

SCALE: 1:500@A1 DATE: April 2023
1:1000@A3

CAD FILE: J:\20448\ASBUILTS\E20448_AB_R0.dwg DRAWN: JS
DRAWING No.: SHEET No.: REVISION:
E.20448.AB.WS02 RO



AMENDMENTS:		
AMENDMENT	DATE	DESCRIPTION

- NOTES:
1. This plan has been prepared for road asbuilt purposes only. No liability is accepted if the plan is used for any other purpose.
 2. Any measurements taken from information which is not dimensioned on the electronic copy are at the risk of the recipient.
 3. Carriageway dimensions shown are from face of kerb to face of kerb.
 4. All roading information is asbuilt.

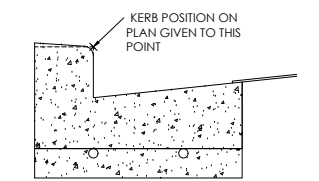

KERB & CHANNEL TO SD601

LEGEND

EXPOSED CONCRETE AGGREGATE	
ASBUILT KERB AND CHANNEL	
ASBUILT CONCRETE FOOTPATH	



116 Wrights Road P O Box 679 Christchurch 8140, New Zealand
 Telephone: 03 379-0793 Website: www.dls.co.nz E-mail: office@dls.co.nz

JOB TITLE:
Rosemerryn - Stage 17

SHEET TITLE:
Roading Asbuilt

DRAWING STATUS:
Asbuilt

SCALE: 1:500@A1
 1:1000@A3 DATE: April 2023

CAD FILE: J:\20448\ASBUILTS\E20448 AB_RD.dwg DRAWN: JS
 DRAWING No: SHEET No: REVISION:
E.20448.AB.RD01 RO

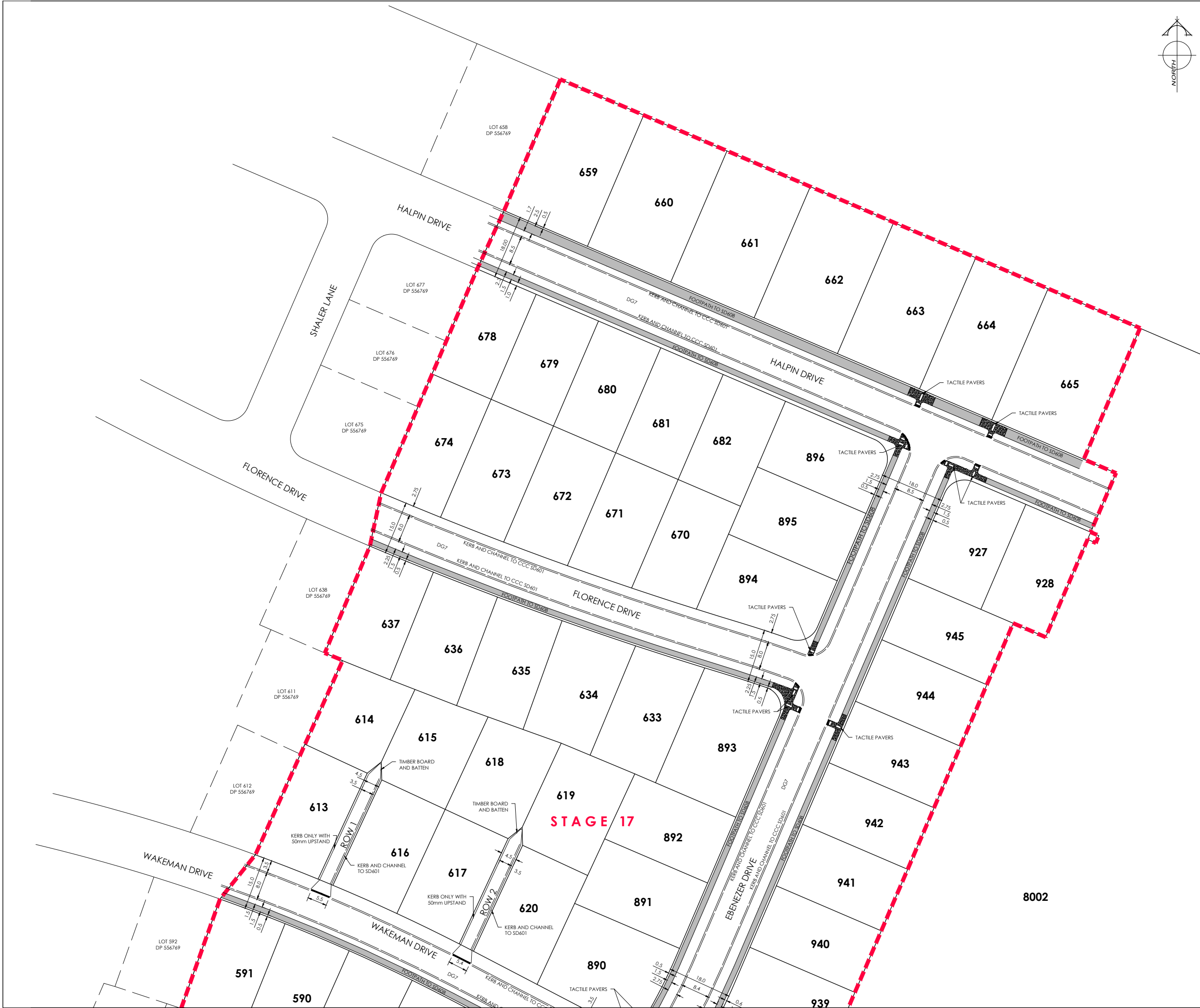

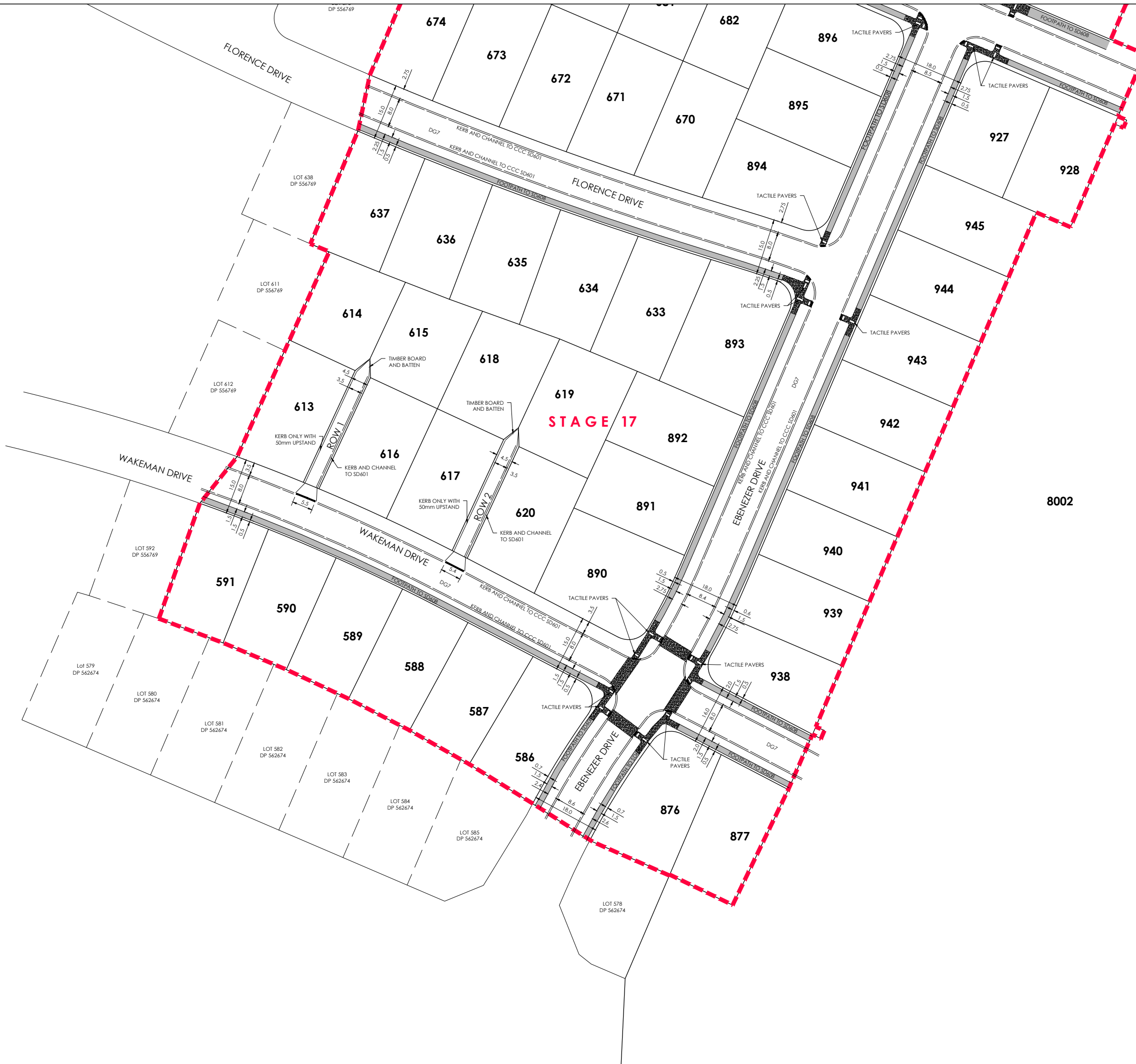
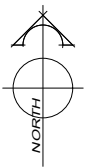

AMENDMENTS:		
AMENDMENT	DATE	DESCRIPTION

- NOTES:
1. This plan has been prepared for road asbuilt purposes only. No liability is accepted if the plan is used for any other purpose.
 2. Any measurements taken from information which is not dimensioned on the electronic copy are at the risk of the recipient.
 3. Carriageway dimensions shown are from face of kerb to face of kerb.
 4. All roading information is asbuilt.

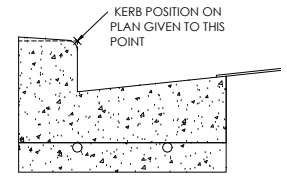

KERB & CHANNEL TO SD601

LEGEND	
EXPOSED AGGREGATE	
ASBUILT KERB AND CHANNEL	
ASBUILT FOOTPATH	



116 Wrights Road P O Box 679 Christchurch 8140, New Zealand
 Telephone: 03 379-0793 Website: www.dls.co.nz E-mail: office@dls.co.nz

JOB TITLE:
Rosemerryn - Stage 17

SHEET TITLE:
Roading Asbuilt

DRAWING STATUS:
Asbuilt

SCALE: 1:500@A1 DATE: April 2023
 1:1000@A3

CAD FILE: J:\20448\ASBUILTS\E20448 AB_RD.dwg DRAWN: JS
 DRAWING No: SHEET No: REVISION:
E.20448.AB.RD02 RO